

# Osceola

## Cities & Villages

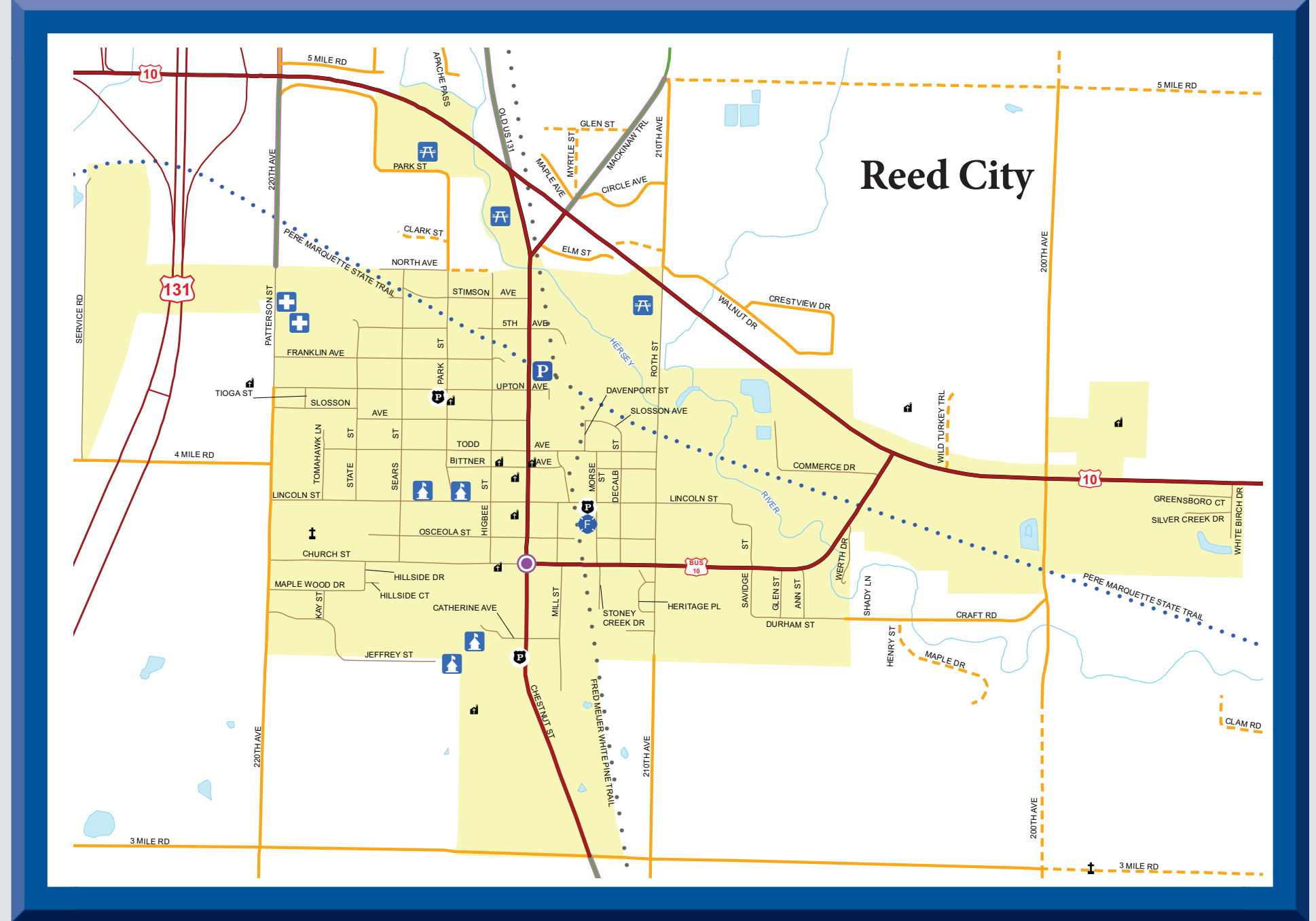

### E-911 Addressing Method

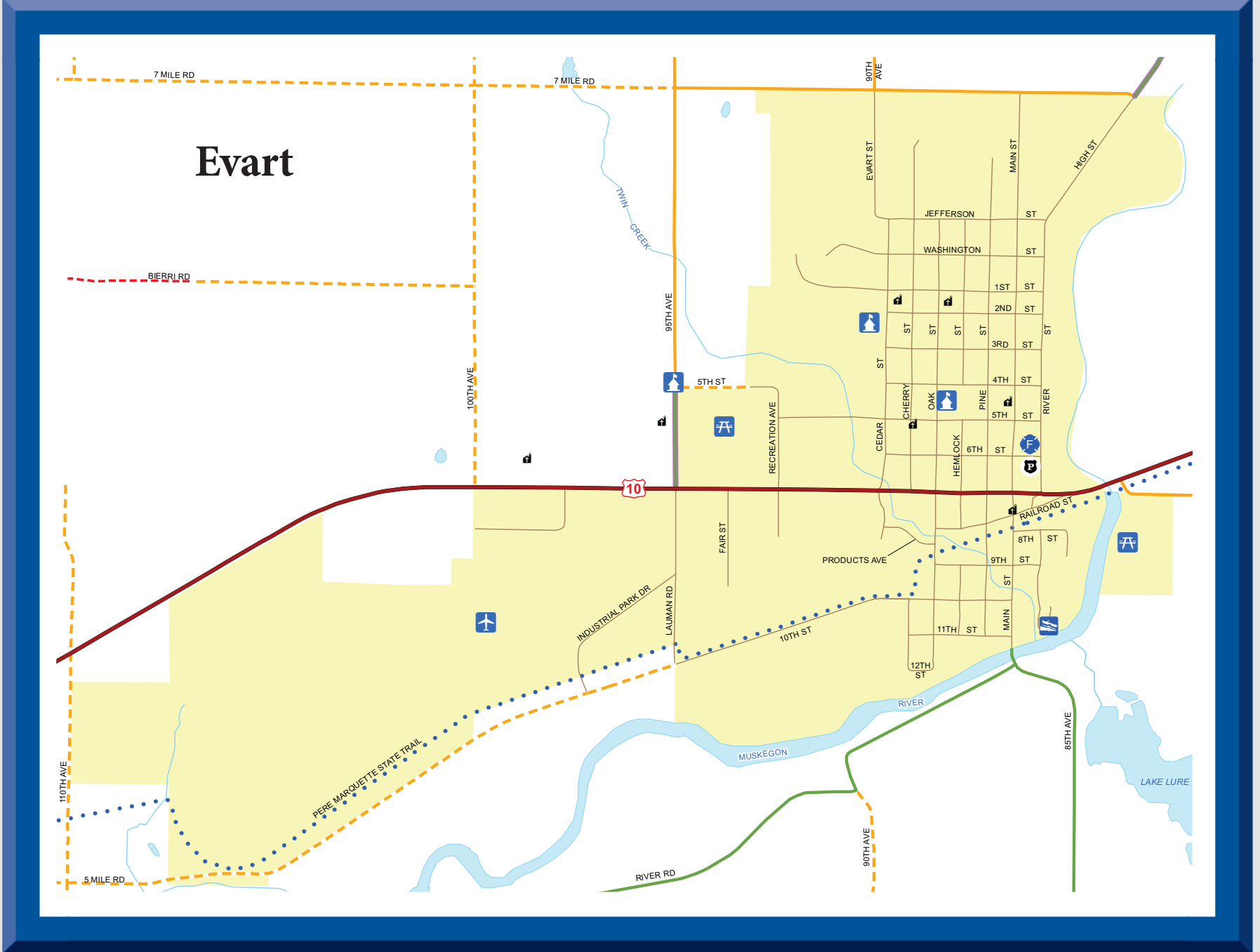
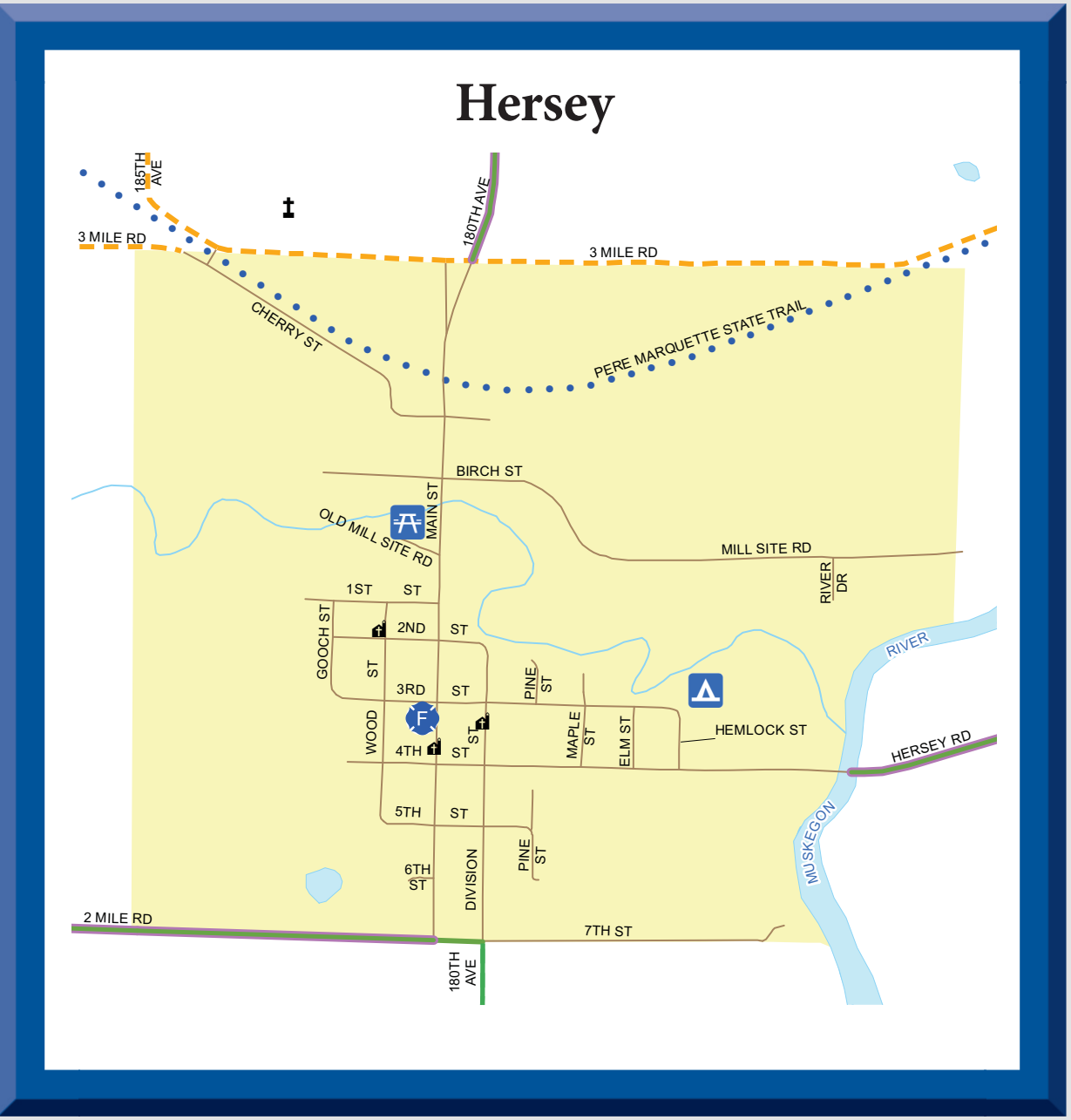
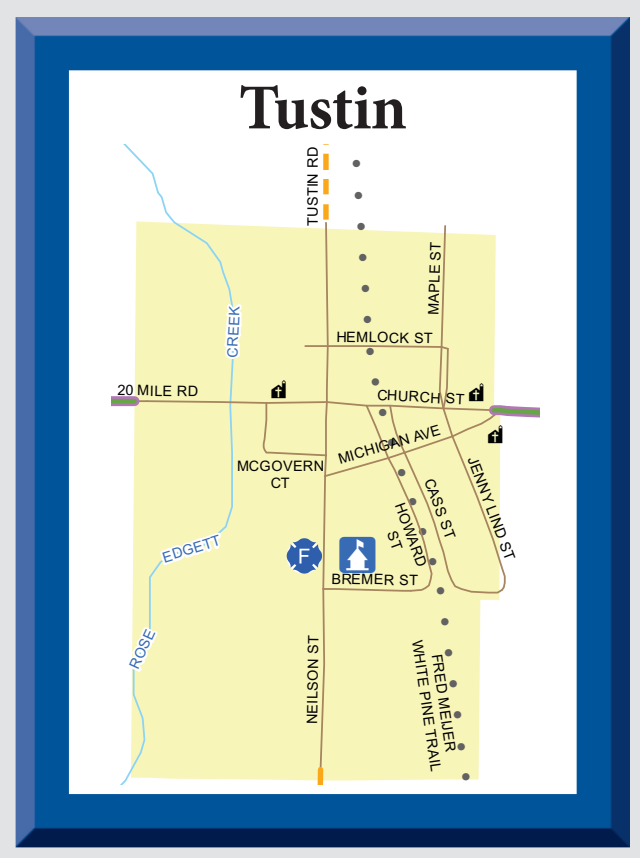
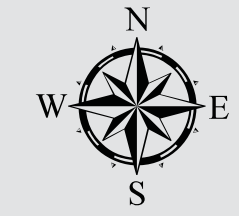
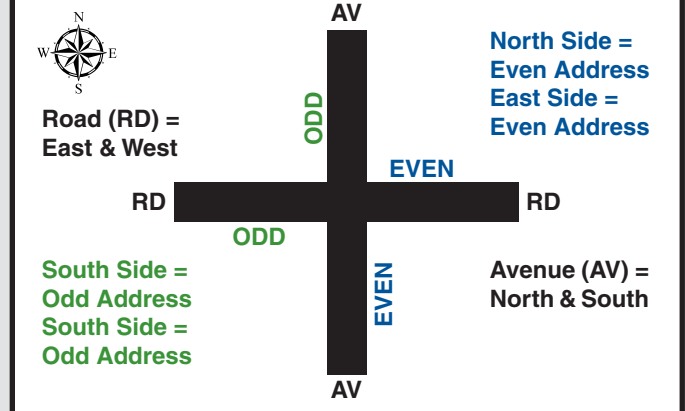

The Osceola County 911 address system is setup in a "grid" format to easily enable you to find an address.

North-south county roads in the county are known as "avenues" and east-west county roads are known as "roads." The five digit numerical designation indicates where the address is located between two specific roads. Numbers ending with an odd number will be on the west side of the avenue or the south side of the road; even numbered residences will be on the east side of the avenue and on the north side of the road. An example would be 16093 190th Ave; 16 tells you that the residence is located on the 190th Avenue between 16 & 17 Mile Roads. The 3 indicates the west side of the avenue.

The numbers are then established with the smallest numbers in the southeast part of the county, getting progressively larger as you travel northwest.

**mappingsolutions**  
 Backed by experience, driven by technology.  
 15415 State Route 92  
 Kearney, MO 64660  
 816-903-3500  
 816-903-3012 fax  
 www.mappingsolutionsGIS.com